

# SYSTEMS UNDER PROTECTION

## DETAILS

These drawings are recommended by the manufacturer to give a way of fixing in situ but could be amended following local regulations in consultation with the manufacturer

### Upstands on waterproofing system under protection without insulation

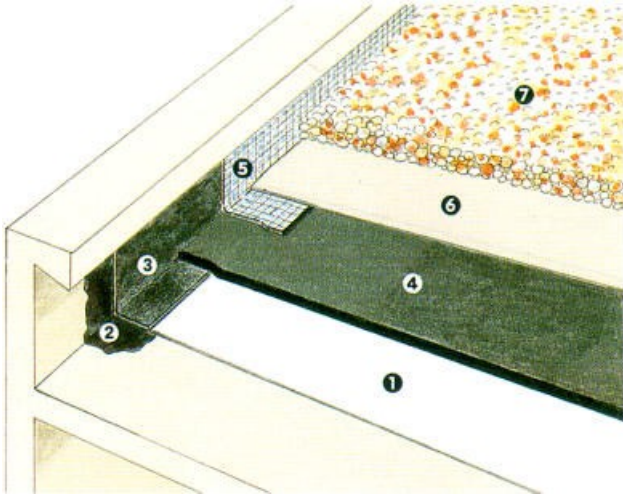

- ❶ MAT 100
- ❷ AXTER Primer into upstand
- ❸ Reinforcement strip HYRENE 35 PY up to the top of the upstand
- ❹ AXTER single layer FORCE or EXCEL membrane

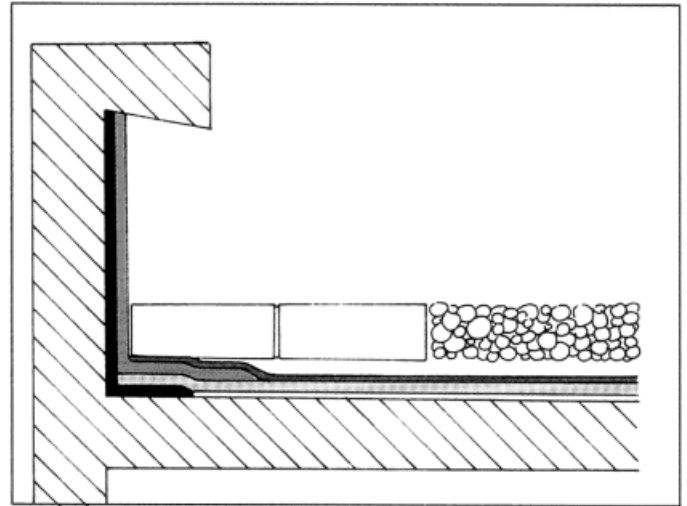

- ❺ PAXALPHA, ARMALU, FORCE or EXCEL
- ❻ Separation layer : Sand or non-woven polyester (Optional in certain cases)
- ❼ PROTECTION : paving slabs, ballast.

### Upstands on waterproofing under concrete

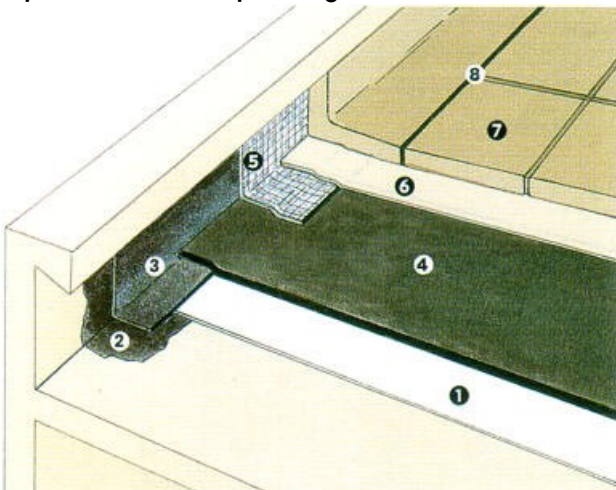

- ❶ MAT 100
- ❷ AXTER Primer into upstand
- ❸ Reinforcement strip HYRENE 35 PY up to the top of the upstand
- ❹ AXTER single layer FORCE, EXCEL or HYRANGER membrane

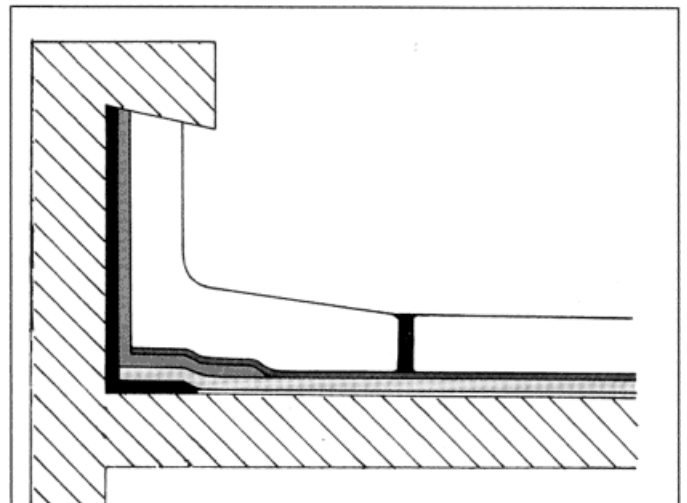

- ❺ PAXALPHA, ARMALU, FORCE or EXCEL
- ❻ Separation layer : non-woven polyester, sand or MAT P
- ❼ PROTECTION : screed to falls concrete
- ❽ Joint: Mastic HYRAFLEX

## Upstands on waterproofing system with insulation

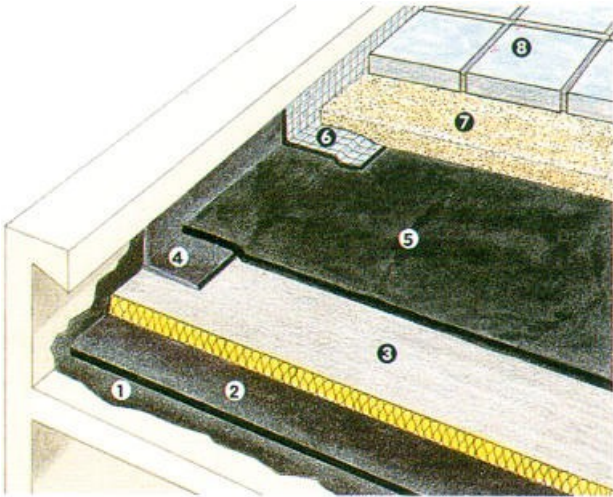

- ❶ AXTER Primer
- ❷ Vapour barrier
- ❸ Insulation
- ❹ Reinforcement strip HYRENE 35 PY up to the top

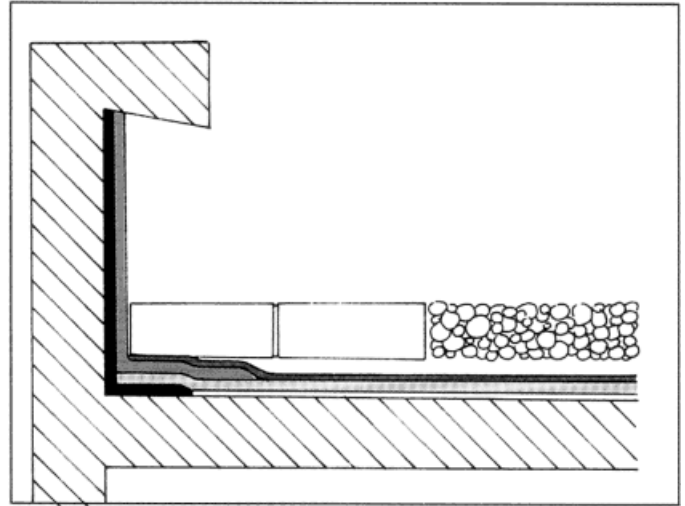

- ❺ AXTER single layer FORCE or EXCEL membrane.
- ❻ Detailing material (ARMA, ARMALU...)
- ❼ Separation layer : non-woven polyester or MAT P or sand screen
- ❽ PROTECTION: Paving slab, concrete slabs, etc...

## Movement joint for waterproofing system under protection

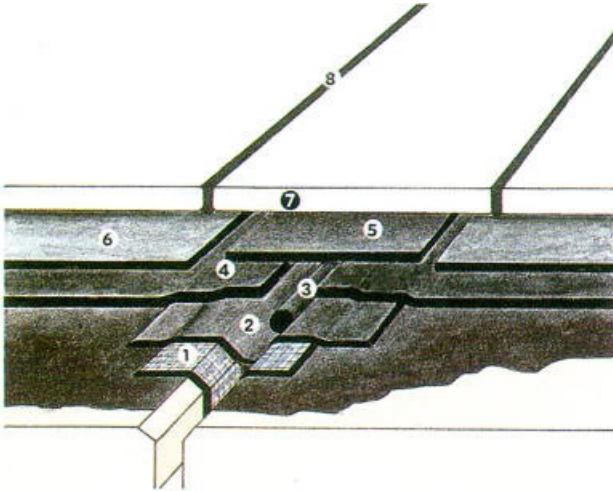

- ❶ PAXALPHA
- ❷ EXCEL JOINT 0.50
- ❸ BUTYL CORD
- ❹ AXTER single layer FORCE or EXCEL membrane

\* NB : If protection is chippings, refer to movement joints on exposed roofs.

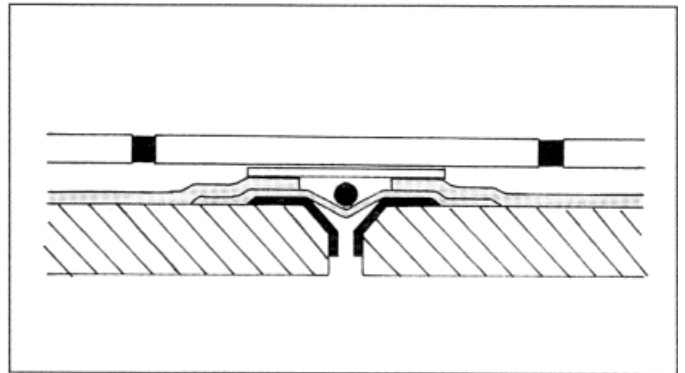

- ❺ Bridge membrane HYRENE 35 PY over 50cm width
- ❻ Separation layer
- ❼ PROTECTION: Concrete slabs or paving slabs
- ❽ Joint: MASTIC HYRAFLEX

## Detail angle on upstands

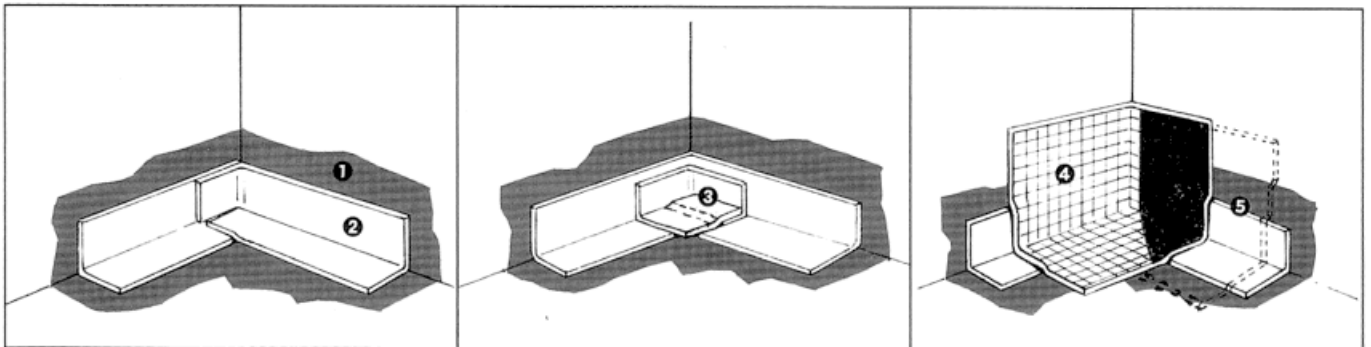

- ❶ AXTER Primer.
- ❷ Reinforcement strip

- ❸ Double reinforcement torch on first layer.

- ❹ Detailing material
- ❺ Where overlapped on itself the granules or aluminium surface should first be removed