

- 1 Hyranger SPOT under-layer
- 2 Excel HRS capping sheet
- 3 Hytherm ADH tapered/flat board  
Insulation (thickness to achieve design  
U-value and/or design fall)
- 4 Plywood base  
(applied locally to reinforce insulation)
- 5 Metal retaining angle
- 6 35py Angle Strip
- 7 Excel HRS Detail Membrane
- 8 Vernis Antac ST primer
- 9 VAP AL Vapour Control Layer
- 10 Concrete substrate  
(by specialist subcontractor)

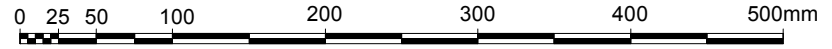
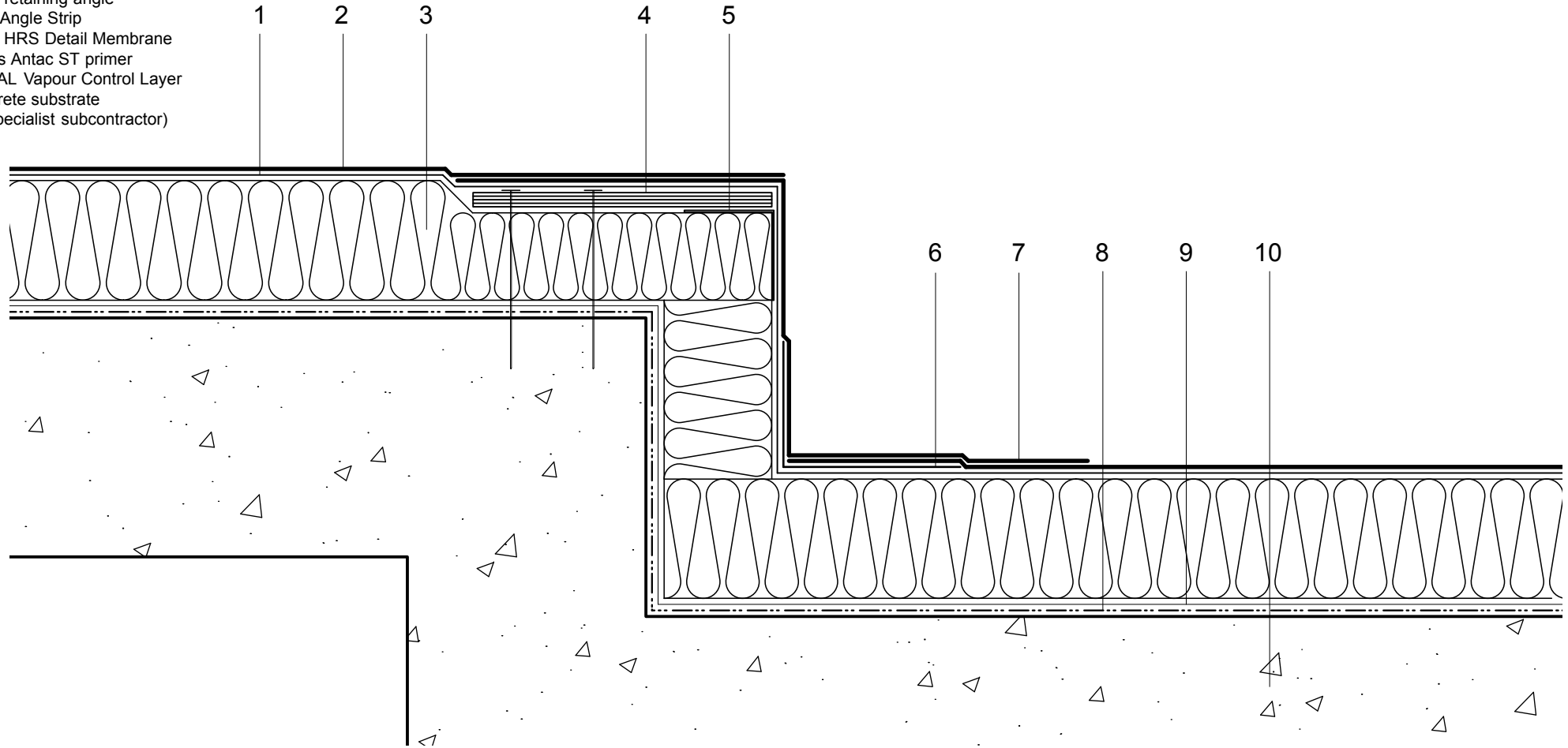

Do Not Scale. All dimensions to be checked on site by the Axtershield Installer

Axter provides detail drawings as part of our technical design service. Such drawings should only be used as a guide during the design process and should not be utilised during construction. Axter accepts no liability for misuse of this service.

PROJECT	AXTER - STANDARD DETAIL
DRAWING NUMBER	WR.C.EX.110

DRAWING	AXTER WARM ROOF - EXCEL/SPOT SYSTEM TYPICAL CHANGE IN ROOF LEVEL/BOX GUTTER EDGE DETAIL - CONCRETE SUBSTRATE	
SCALE	1:5 @ A4	DATE
		2014

AXTER LTD  
West Road, Ransomes  
Europark, Ipswich,  
Suffolk, IP3 9SX.  
Tel:(01473)724056  
Fax:(01473)723263  
info@axterltd.co.uk

