

- 1 Perforated Layer
- 2 FORCE LINE 2/3 VV under-layer
- 3 FORCE LINE 4/4.5 capping sheet
- 4 Hytherm ADH tapered/flat board
- 5 Insulation (thickness to achieve design U-value and/or design fall)
- 6 Metal support angle
- 7 FORCE LINE 4/4.5 detail membrane
- 8 Vernis Antac ST primer
- 9 Vap AL Vapour Barrier
- 10 Timber hard edge
- 11 Axtrim Perimeter Trim (to suit design requirements)
- 12 Hytherm BF bitumen faced upstand insulation to mitigate cold bridge
- 13 Axter RO overflow outlet with preformed membrane flange and pipe extension as required to suit parapet width - dimensions to be taken on site (90° downturn)
- 14 Plywood substrate laid to minimum 1:80 falls (falls unnecessary when using tapered insulation) by specialist contractor
- 15 Metal retaining angle

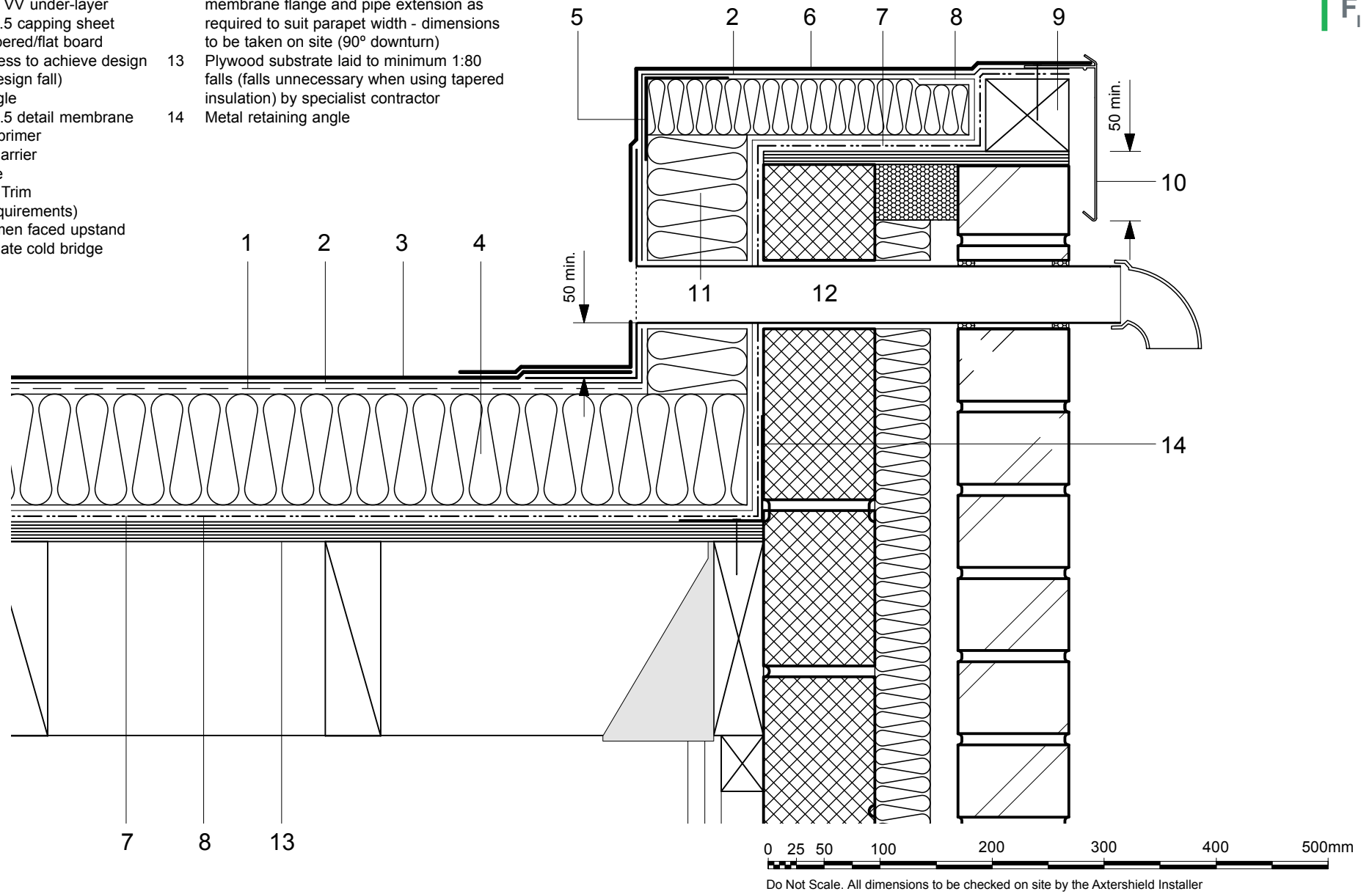

Axter provides detail drawings as part of our technical design service. Such drawings should only be used as a guide during the design process and should not be utilised during construction. Axter accepts no liability for misuse of this service.

PROJECT	AXTER - STANDARD DETAIL
DRAWING NUMBER	WR.P.FL.081

DRAWING	AXTER WARM ROOF - FORCE LINE SYSTEM TYPICAL PARAPET RAIN WATER OVERFLOW DETAIL - PLYWOOD SUBSTRATE	
SCALE	1:5 @ A4	DATE
		2014

AXTER LTD
West Road, Ransomes
Europark, Ipswich,
Suffolk, IP3 9SX.
Tel:(01473)724056
Fax:(01473)723263
info@axterltd.co.uk

