

- 1 Axter Rainwater outlet
- 2 Universal leaf guard (to suit design requirements)
- 4 Perforated Layer
- 6 FORCE LINE 2/3 VV under-layer
- 5 FORCE LINE 4/4.5 capping sheet
- 6 Hytherm ADH tapered/flat board
Insulation (thickness to achieve design
U-value and/or design fall)
- 7 Vernis Antac ST primer
- 8 Axter Vapour Control Layer
- 9 Plywood substrate laid to minimum 1:80
falls (falls unnecessary when using tapered
insulation) by specialist contractor
- 10 Plywood sump base
- 11 Metal retaining angle

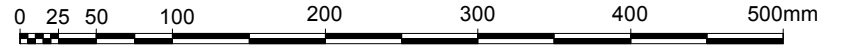
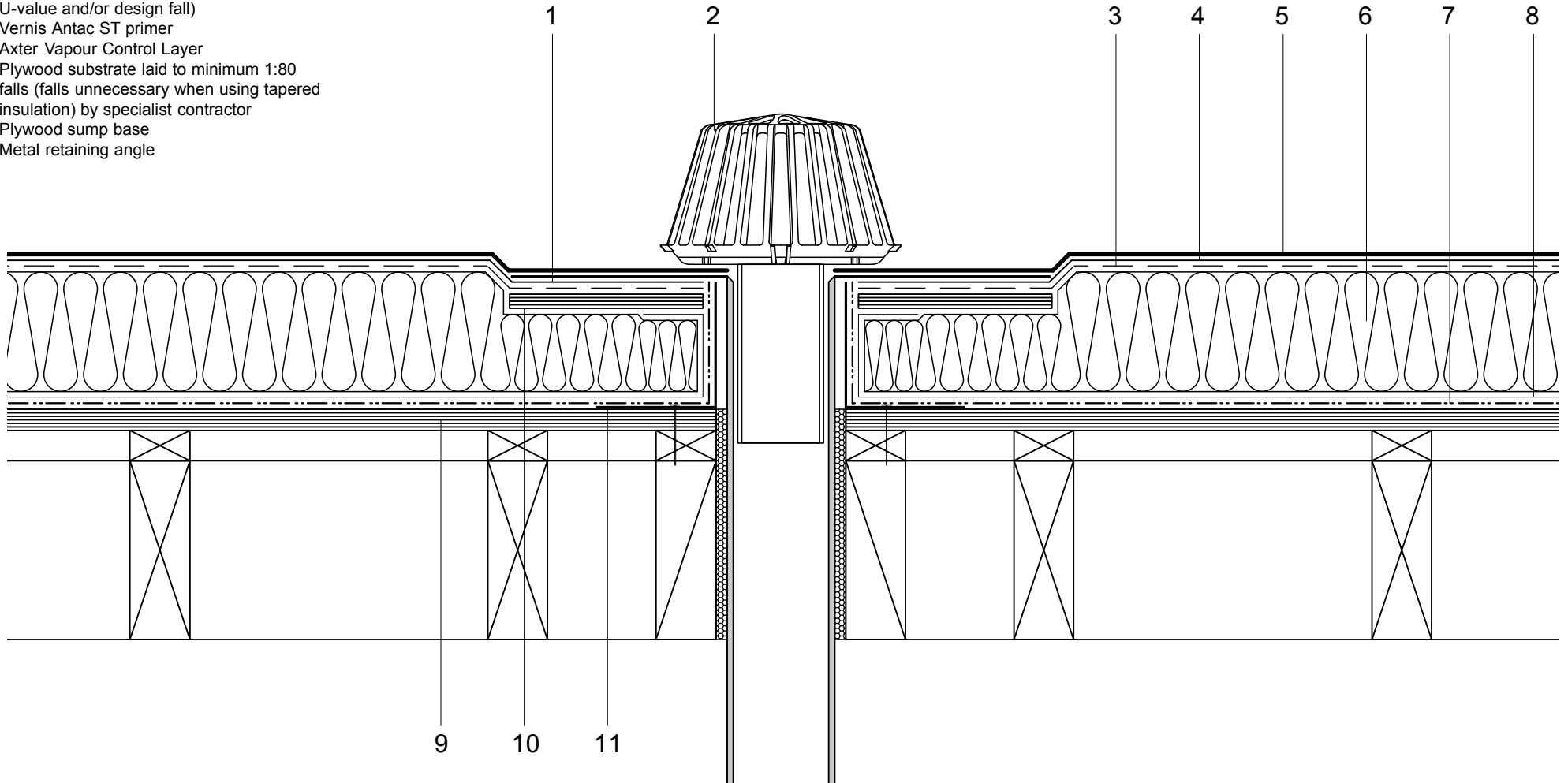

Do Not Scale. All dimensions to be checked on site by the Axtershield Installer

Axter provides detail drawings as part of our technical design service. Such drawings should only be used as a guide during the design process and should not be utilised during construction. Axter accepts no liability for misuse of this service.	PROJECT AXTER - STANDARD DETAIL	DRAWING AXTER WARM ROOF - FORCE LINE SYSTEM TYPICAL VERTICAL RAIN WATER OUTLET DETAIL - PLYWOOD SUBSTRATE		AXTER LTD West Road, Ransomes Europark, Ipswich, Suffolk, IP3 9SX. Tel: (01473) 724056 Fax: (01473) 723263 info@axterltd.co.uk	
	DRAWING NUMBER WR.P.FL.90	SCALE 1:5 @ A4	DATE 2014		