

- 1 Perforated Layer
- 2 FORCE LINE 2/3 VV under-layer
- 3 FORCE LINE 4/4.5 capping sheet
- 4 Hytherm ADH tapered/flat board
- 5 Insulation (thickness to achieve design U-value and/or design fall)
- 6 Vernis Antac ST primer
- 7 Axter Vapour Control Layer
- 8 Timber hard edge/batten
- 9 FORCE LINE to form welted drip detail
- 10 Lead apron flashing (by specialist subcontractor) fixed in accordance to Lead Sheet Association Guide
- 11 Concrete substrate (by specialist contractor)

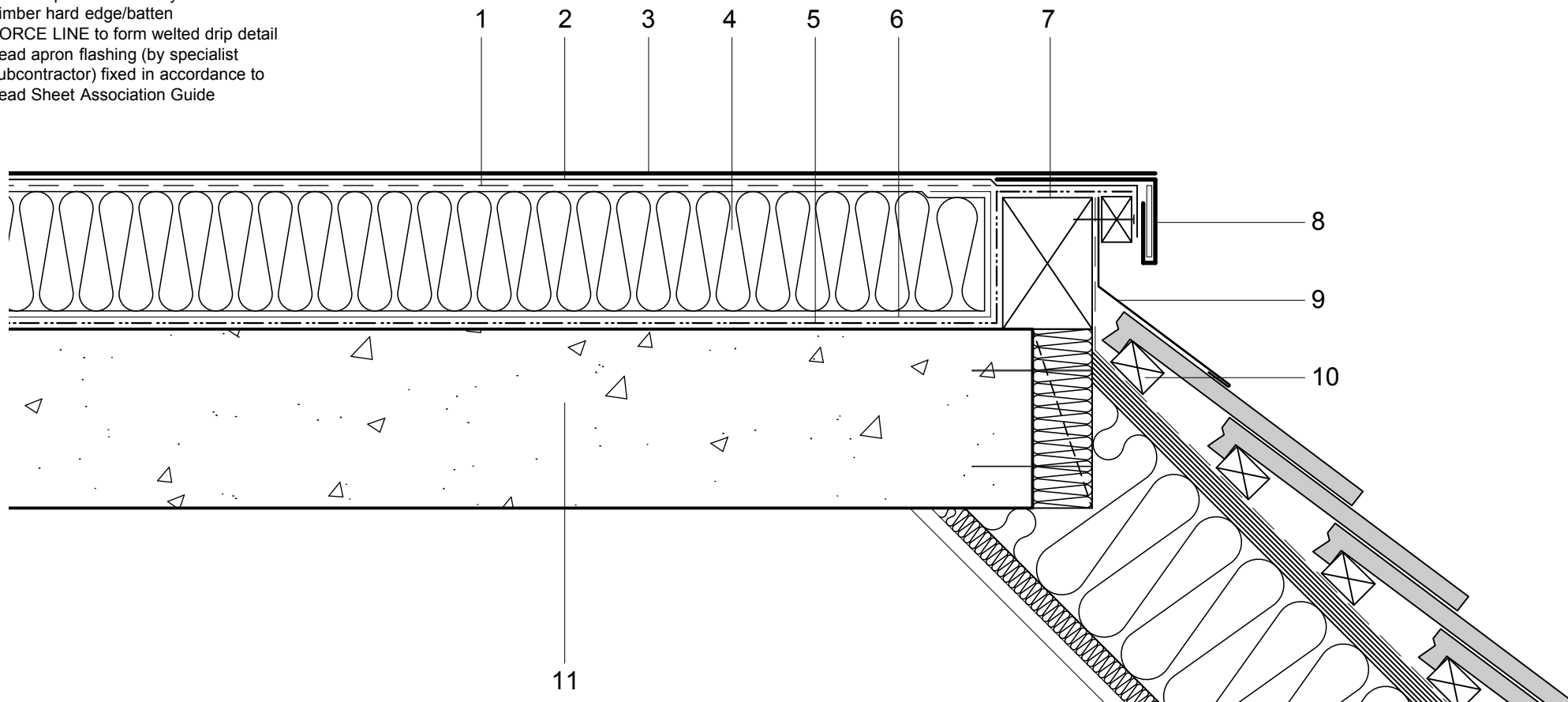

Do Not Scale. All dimensions to be checked on site by the Axtershield Installer

Axter provides detail drawings as part of our technical design service. Such drawings should only be used as a guide during the design process and should not be utilised during construction. Axter accepts no liability for misuse of this service.

PROJECT	AXTER - STANDARD DETAIL	
DRAWING NUMBER	WR.C.FL.120	

DRAWING	AXTER WARM ROOF - FORCE LINE SYSTEM TYPICAL MANSARD EDGE DETAIL - CONCRETE SUBSTRATE	
SCALE	1:5 @ A4	DATE
		2014

AXTER LTD  
 West Road, Ransomes  
 Europark, Ipswich,  
 Suffolk, IP3 9SX.  
 Tel: (01473) 724056  
 Fax: (01473) 723263  
 info@axterltd.co.uk

