

- 1 ECOLINE ADH fleeceback
single ply membrane fully bonded
using ADH Adhesive
- 2 Hytherm tapered/flat board Insulation
mechanically fixed with Ecoline insulation
washers and fixings (thickness to achieve
design U-value and/or design fall)
- 3 ECO/D cover strip with sufficient expansion loop
- 4 Restraint bar and mechanical (C) fixing
- 5 Fireproof compressible filler by specialist contractor
- 6 Heat welded seam - 40mm
- 7 Vernis Antac ST primer
- 8 Axter Vapour Control Layer
- 9 Concrete substrate
(by specialist subcontractor)
- 10 Vertical movement joint/Galvanised bent metal
angle mechanically fixed at perimeter
(by specialist subcontractor)
- 11 ADH Adhesive

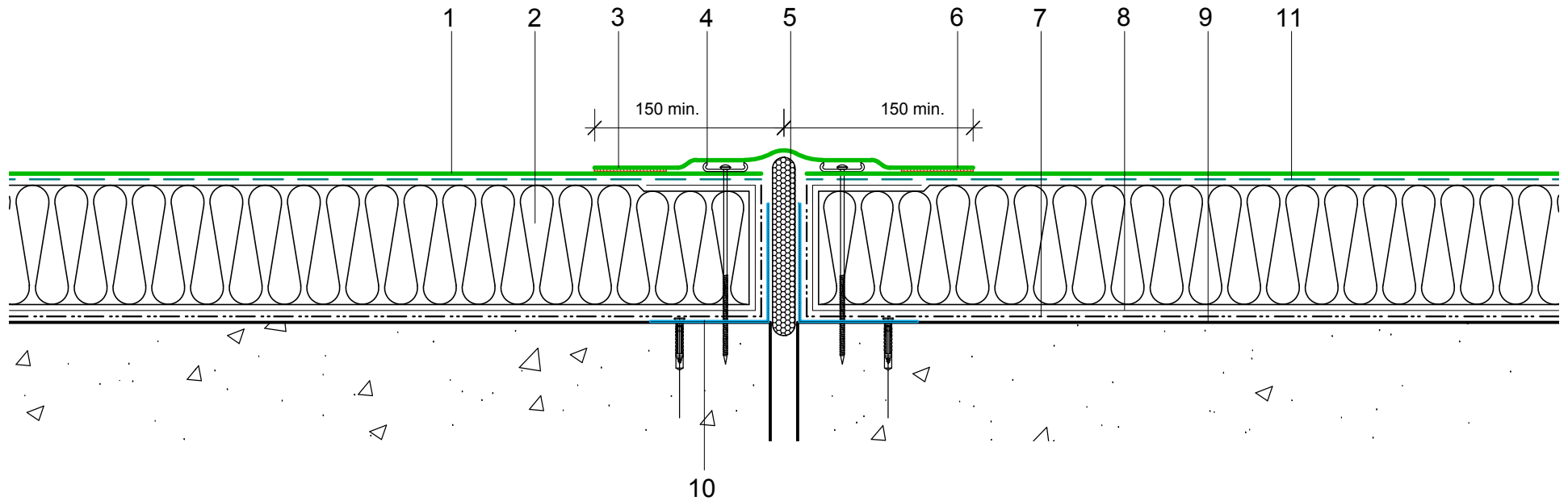

Do Not Scale. All dimensions to be checked on site by the Axtershield Installer

Axter provide detail drawings as part of our technical design service. Such drawings should only be used as a guide during the design process and should not be utilised during construction. Axter accepts no liability for misuse of this service.

<p>PROJECT</p> <p style="text-align: center;">AXTER - STANDARD DETAIL</p>	<p>DRAWING</p> <p style="text-align: center;">AXTER WARM ROOF - ECOLINE ADH SYSTEM TYPICAL VERTICAL MOVEMENT JOINT DETAIL - CONCRETE SUBSTRATE</p>				
	<p>CLIENT</p> <p style="text-align: center;">N/A</p>	<p>DWG.No</p> <p style="text-align: center;">WR.C.EL.adh.160</p>			



www.axter.co.uk
info@axterltd.co.uk
01473 724 056

Axter Ltd,
West Road, Ransomes Europark,
Ipswich, Suffolk, IP3 9SX