

- 1 ECOLINE ADH fleeceback single ply membrane fully bonded using ADH Adhesive
- 2 Hytherm tapered/flat board Insulation mechanically fixed with Ecoline insulation washers and fixings (thickness to achieve design U-value and/or design fall)
- 3 ECO/R coverstrip
- 4 ECOMETAL preformed PVC coated metal trim as hard edge
- 5 ECOLINE ADH single ply membrane
- 6 Heat welded seam - 40mm
- 7 Vernis Antac ST primer
- 8 Axter Vapour Control Layer
- 9 Plywood substrate (by specialist subcontractor)
- 10 Restraint bar and mechanical (MTP) fixing
- 11 ADH Adhesive

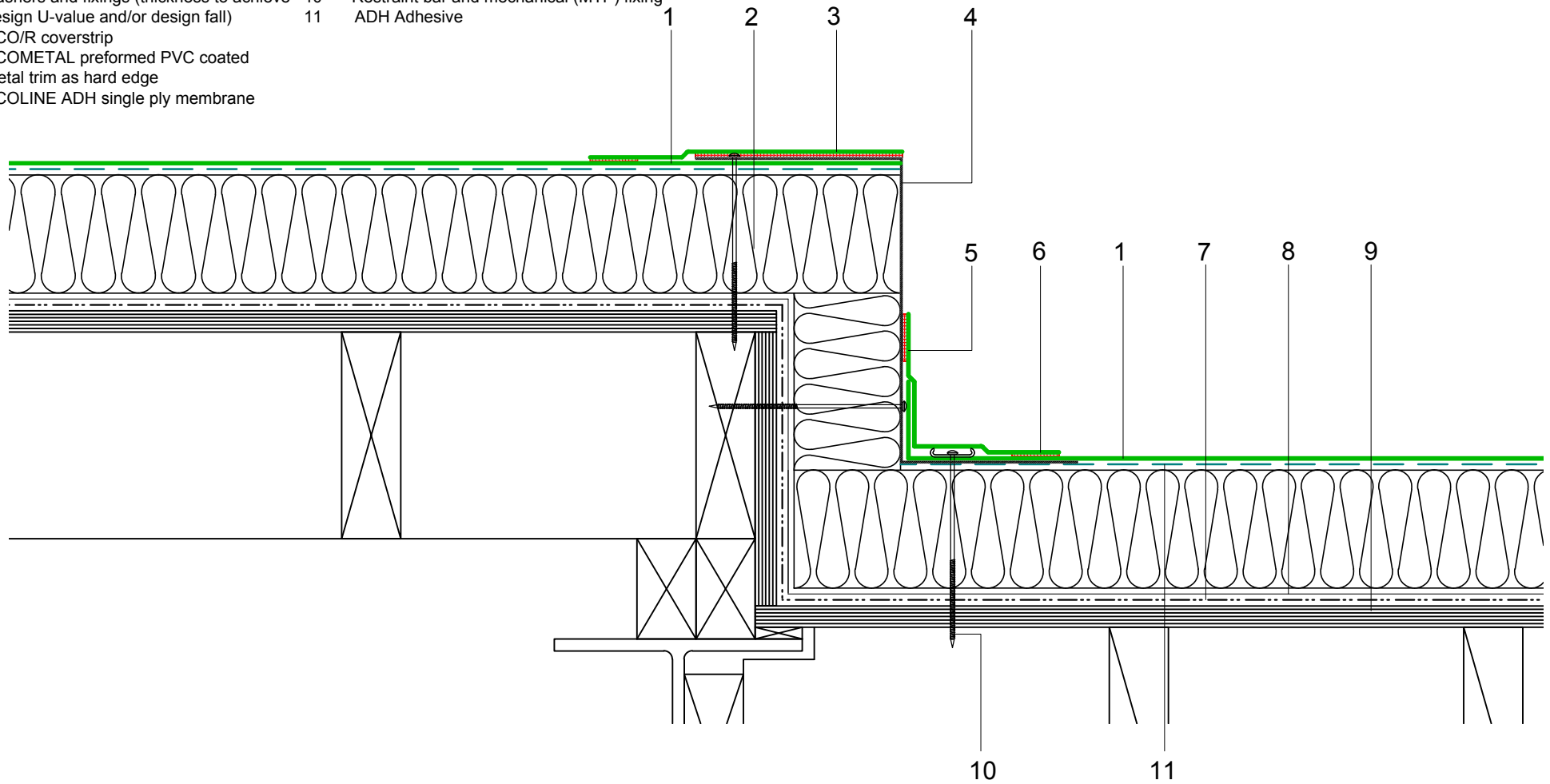

Do Not Scale. All dimensions to be checked on site by the Axtershield Installer

Axter provide detail drawings as part of our technical design service. Such drawings should only be used as a guide during the design process and should not be utilised during construction. Axter accepts no liability for misuse of this service.

PROJECT	AXTER - STANDARD DETAIL		DRAWING AXTER WARM ROOF - ECOLINE ADH SYSTEM TYPICAL CHANGE IN ROOF LEVEL/BOX GUTTER EDGE DETAIL - PLYWOOD SUBSTRATE			
	CLIENT	N/A	DWG.No	SCALE	DATE	REV
			WR.P.EL.adh.100	1:5 @ A4	10.16	N/A



www.axter.co.uk
info@axterltd.co.uk
01473 724 056

Axter Ltd.
West Road, Ransomes Europark,
Ipswich, Suffolk, IP3 9SX