

- 1 Batten and tiles/slates
(by specialist subcontractor)
- 2 Sarking felt (by specialist subcontractor)
- 3 Tilting fillet/Mechanical fixing
(by specialist subcontractor)
- 4 Plywood layer board
(by specialist subcontractor)
- 5 FM/D contact adhesive
- 6 Restraint bar and mechanical (MTP) fixing
- 7 ECOLINE FM single ply membrane
- 8 Heat welded seam - 40mm
- 9 ECOLINE ADH fleeceback
single ply membrane fully bonded
using ADH Adhesive
- 10 Hytherm tapered/flat board Insulation
mechanically fixed with Ecoline Insulation
washers and fixings (thickness to achieve
design U-value and/or design fall)
- 11 Vernis Antac ST primer
- 12 Axter Vapour Control Layer
- 13 Plywood substrate
(by specialist subcontractor)
- 14 ECO/200 Separation membrane (taped)
- 15 ADH Adhesive

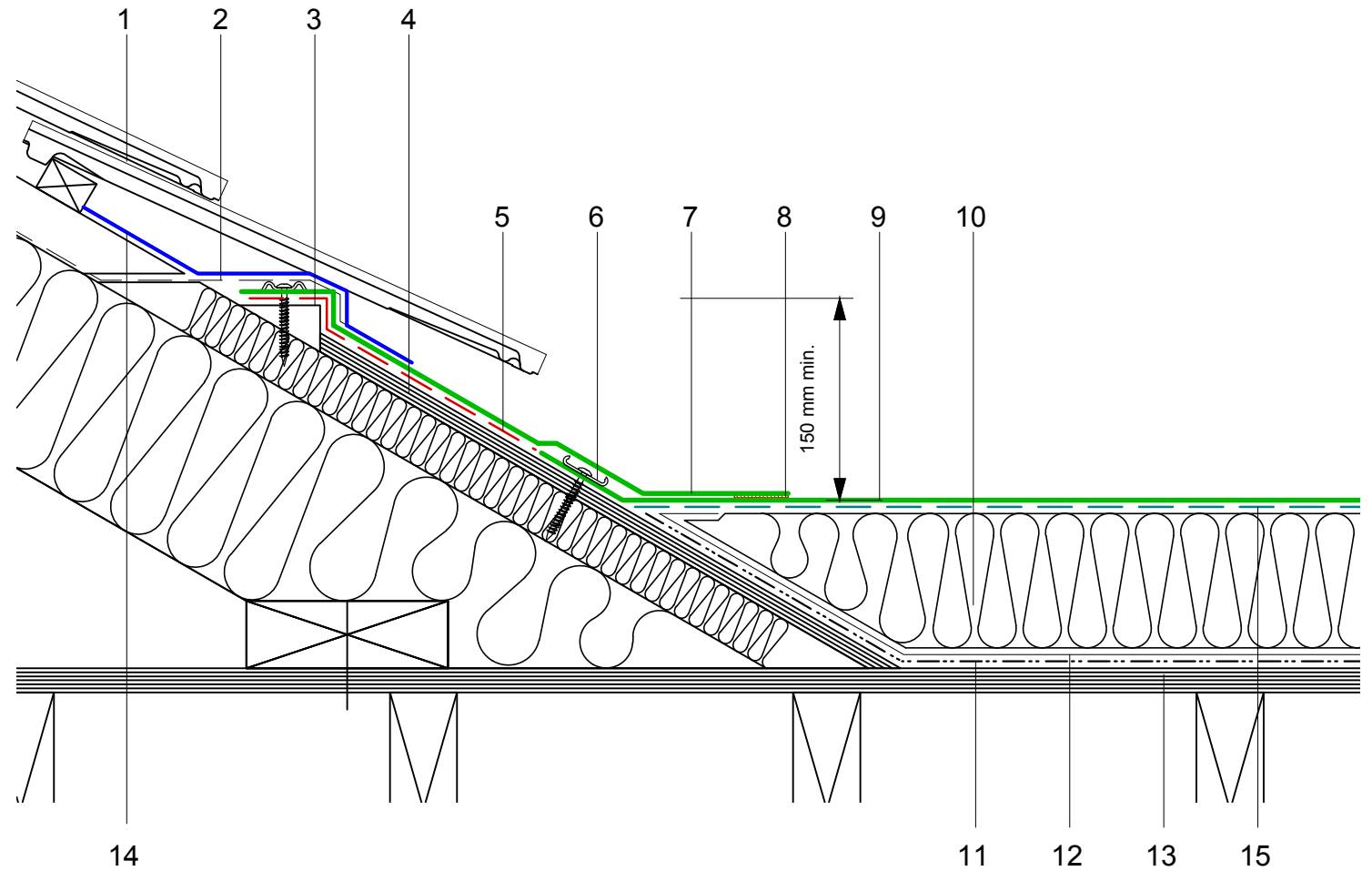

Do Not Scale. All dimensions to be checked on site by the Axtersfield Installer

Axter provide detail drawings as part of our technical design service. Such drawings should only be used as a guide during the design process and should not be utilised during construction. Axter accepts no liability for misuse of this service.

PROJECT	AXTER - STANDARD DETAIL		DRAWING			
			AXTER WARM ROOF - ECOLINE ADH SYSTEM PITCHED TO FLAT ROOF ABUTMENT DETAIL - PLYWOOD SUBSTRATE			
CLIENT	N/A	DWG.No	SCALE	DATE	REV	
		WR.P.EL.adh.120	1:5 @ A4	10.16	N/A	



www.axter.co.uk
info@axterltd.co.uk
01473 724 056

Axter Ltd.
West Road, Ransomes Europark,
Ipswich, Suffolk, IP3 9SX