

- 1 Axter Rainwater outlet with PVC membrane flange
- 2 Heat welded seam to field membrane
- 3 Axter Universal leaf guard (to suit design requirements)
- 4 ECOLINE FM single ply membrane mechanically fixed with Ecoline membrane washers and (MTP) fixings
- 5 Hytherm tapered/flat board Insulation mechanically fixed with Ecoline insulation washers and fixings (thickness to achieve design U-value and/or design fall)
nb: Insulation locally sumped (30mm min) on site by Axtershield Installer
- 6 Vernis Antac ST primer
- 7 Axter Vapour Control Layer
- 8 Plywood substrate (by specialist subcontractor)
- 9 ECOLINE Tubular Washer and mechanical fastener (MTP) fixing
- 10 Galvanised bent metal angle mechanically fixed at perimeter (by specialist subcontractor)

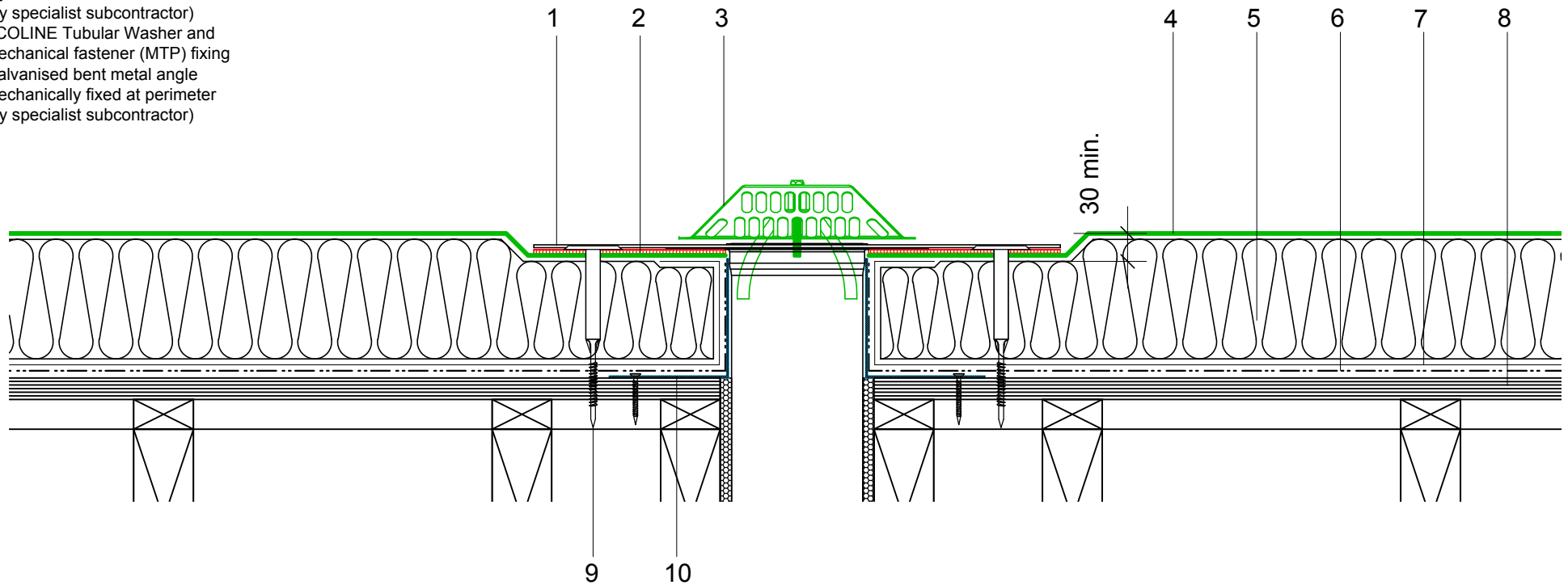

Do Not Scale. All dimensions to be checked on site by the Axtershield Installer

Axter provide detail drawings as part of our technical design service. Such drawings should only be used as a guide during the design process and should not be utilised during construction. Axter accepts no liability for misuse of this service.

<p>PROJECT</p> <p style="text-align: center;">AXTER - STANDARD DETAIL</p>	<p>DRAWING</p> <p style="text-align: center;">AXTER WARM ROOF - ECOLINE FM SYSTEM TYPICAL VERTICAL RAIN WATER OUTLET DETAIL - PLYWOOD SUBSTRATE</p>					
	<p>CLIENT</p> <p style="text-align: center;">N/A</p>	<p>DWG.No</p> <p style="text-align: center;">WR.P.EL.fm.80</p>	<p>SCALE</p> <p style="text-align: center;">1:5 @ A4</p>	<p>DATE</p> <p style="text-align: center;">10.16</p>	<p>REV</p> <p style="text-align: center;">N/A</p>	<p>www.axter.co.uk info@axterltd.co.uk 01473 724 056</p> <p style="text-align: right;">Axter Ltd, West Road, Ransomes Europark, Ipswich, Suffolk, IP3 9SX</p>