

- 1 ECOFLEX FM single ply membrane mechanically fixed with Ecoflex membrane washers and (MTP) fixings
- 2 Hytherm tapered/flat board Insulation mechanically fixed with Ecoflex insulation washers and fixings (thickness to achieve design U-value and/or design fall)
- 3 Vernis Antac ST primer
- 4 Axter Vapour Control Layer
- 5 Heat welded seam - 40mm
- 6 ECO/R cover strip
- 7 Mechanically fixed hard edge/batten (by specialist subcontractor)
- 8 ECOMETAL preformed PVC coated metal trim mechanical (MTP) fixing at 200mm ctrs
- 9 Lead apron flashing (by specialist subcontractor) (fixed in accordance to Lead Sheet Association Guide)
- 10 Batten and tiles/slates (by specialist subcontractor)
- 11 Metal deck substrate (by specialist subcontractor)

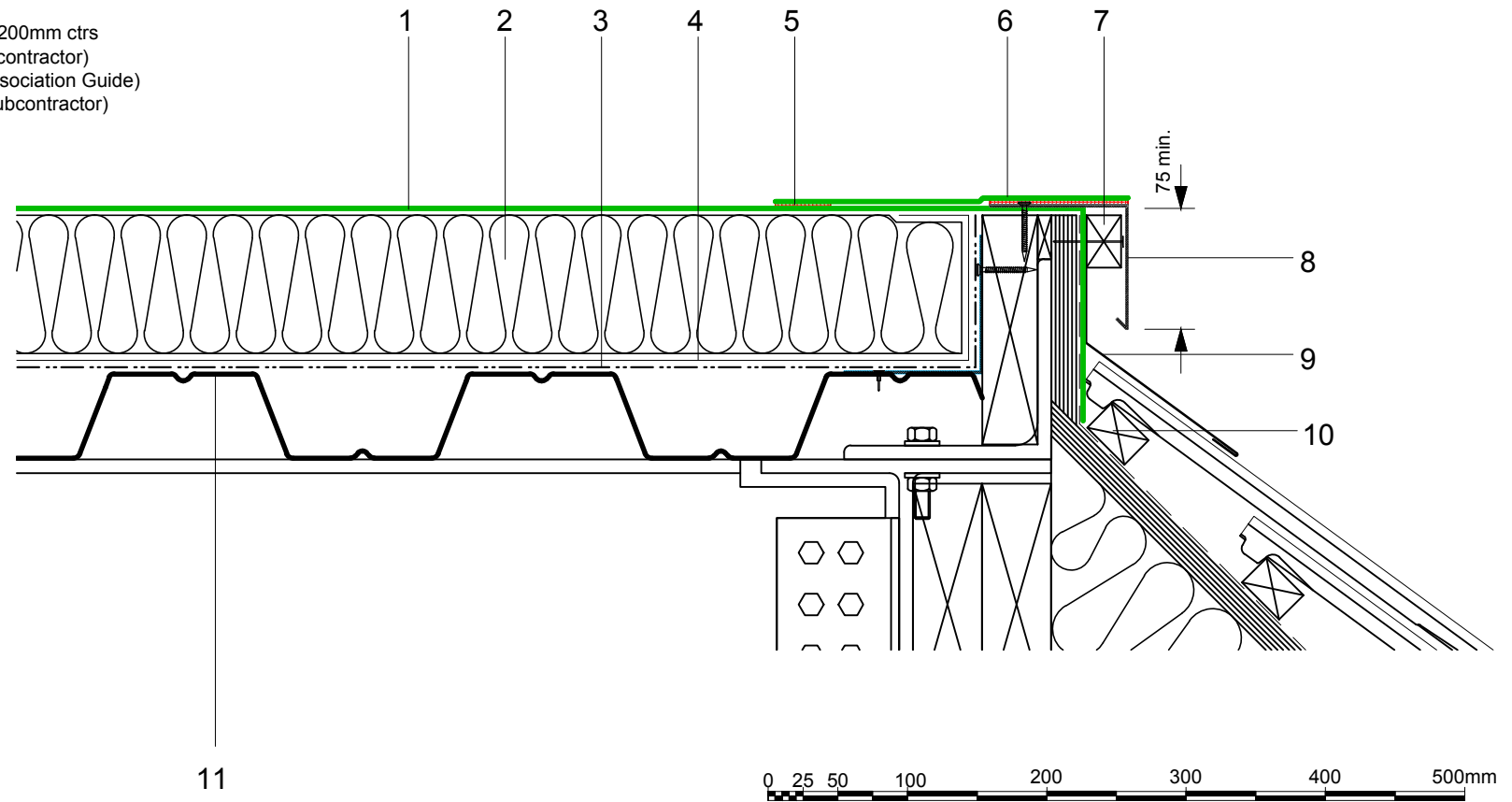

Axter provide detail drawings as part of our technical design service. Such drawings should only be used as a guide during the design process and should not be utilised during construction. Axter accepts no liability for misuse of this service.

PROJECT	AXTER - STANDARD DETAIL
CLIENT	N/A

DRAWING	AXTER WARM ROOF - ECOFLEX FM SYSTEM TYPICAL MANSARD EDGE DRIP DETAIL - METAL DECK			
DWG.No	SCALE	DATE	REV	
WR.M.EF.fm.110	1:5 @ A4	10.16	N/A	



www.axter.co.uk
info@axterltd.co.uk
01473 724 056

Axter Ltd.
West Road, Ransomes Europark,
Ipswich, Suffolk, IP3 9SX