

- 1 Batten and tiles/slates
(by specialist subcontractor)
- 2 Sarking felt (by specialist subcontractor)
- 3 Tilting fillet/Mechanical fixing
(by specialist subcontractor)
- 4 Plywood layer board
(by specialist subcontractor)
- 5 FM/D contact adhesive
- 6 Restraint bar, cord and mechanical (C) fixing
- 7 ECOFLEX FM single ply membrane
- 8 Heat welded seam - 40mm
- 9 ECOFLEX FM single ply membrane
mechanically fixed with Ecoflex
membrane washers and (C) fixings
- 10 Hytherm tapered/flat board Insulation
mechanically fixed with Ecoflex Insulation
washers and fixings (thickness to achieve
design U-value and/or design fall)
- 11 Vernis Antac ST primer
- 12 Axter Vapour Control Layer
- 13 Concrete substrate
(by specialist subcontractor)
- 14 ECO/200 Separation membrane (taped)

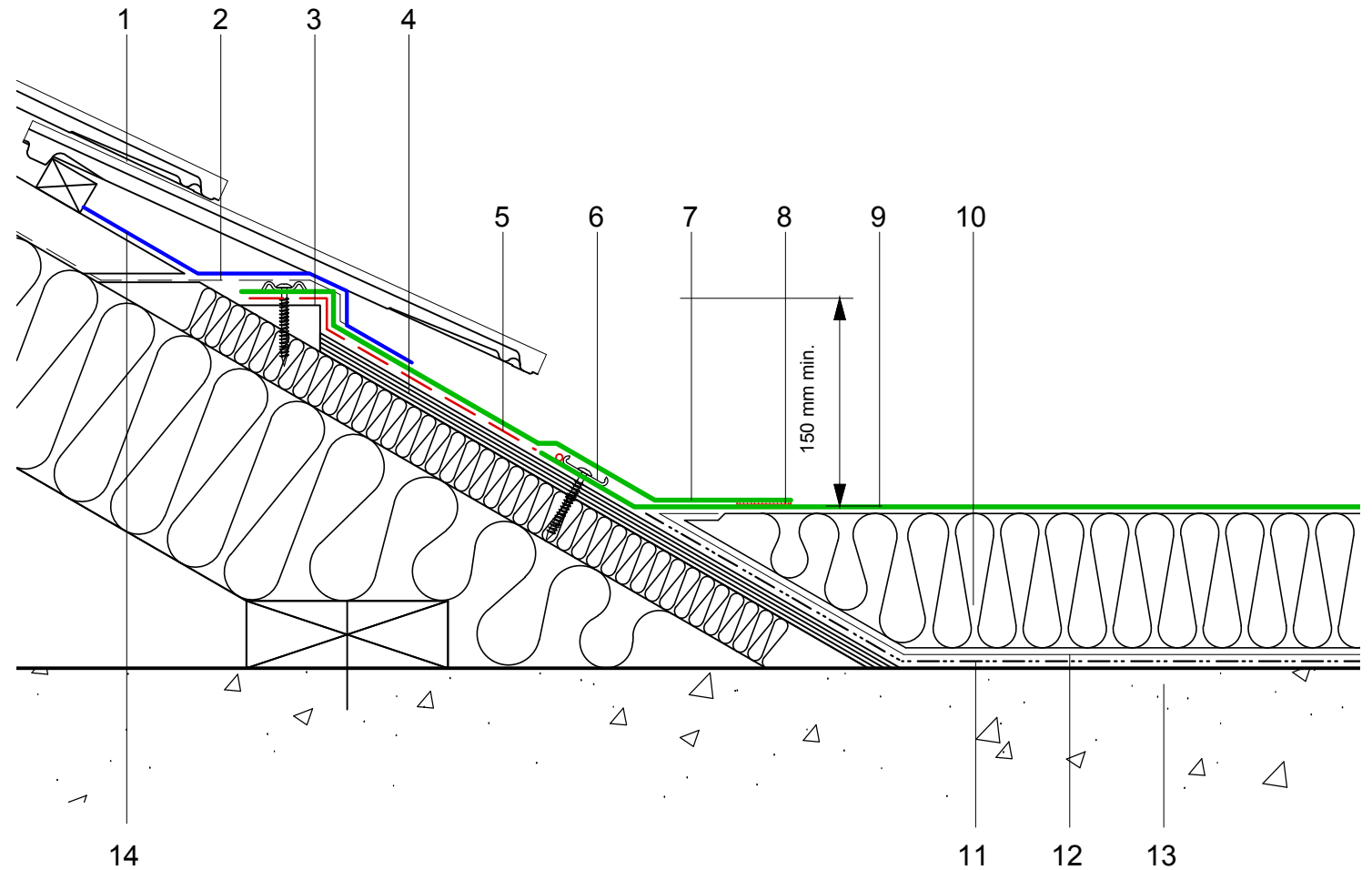

Do Not Scale. All dimensions to be checked on site by the Axtershield Installer

Axter provide detail drawings as part of our technical design service. Such drawings should only be used as a guide during the design process and should not be utilised during construction. Axter accepts no liability for misuse of this service.

PROJECT	AXTER - STANDARD DETAIL		DRAWING			
			AXTER WARM ROOF - ECOFLEX FM SYSTEM PITCHED TO FLAT ROOF ABUTMENT DETAIL - CONCRETE SUBSTRATE			
CLIENT	N/A	DWG.No	SCALE	DATE	REV	
		WR.C.EF.fm.120	1:5 @ A4	10.16	N/A	



www.axter.co.uk
info@axterltd.co.uk
01473 724 056

Axter Ltd.
West Road, Ransomes Europark,
Ipswich, Suffolk, IP3 9SX