

- 1 Axter Rainwater outlet
- 2 Universal leaf guard (to suit design requirements)
- 3 Hyranger SPOT under-layer
- 4 Excel HRS capping sheet
- 5 Hytherm ADH tapered/flat board
Insulation (thickness to achieve design
U-value and/or design fall)
- 6 Vernis Antac ST primer
- 7 VAP AL SK Vapour Control Layer
- 8 Plywood substrate
(by specialist subcontractor)
- 9 Plywood sump base
- 10 Metal retaining angle

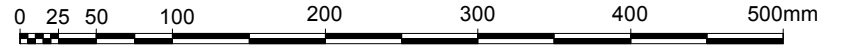
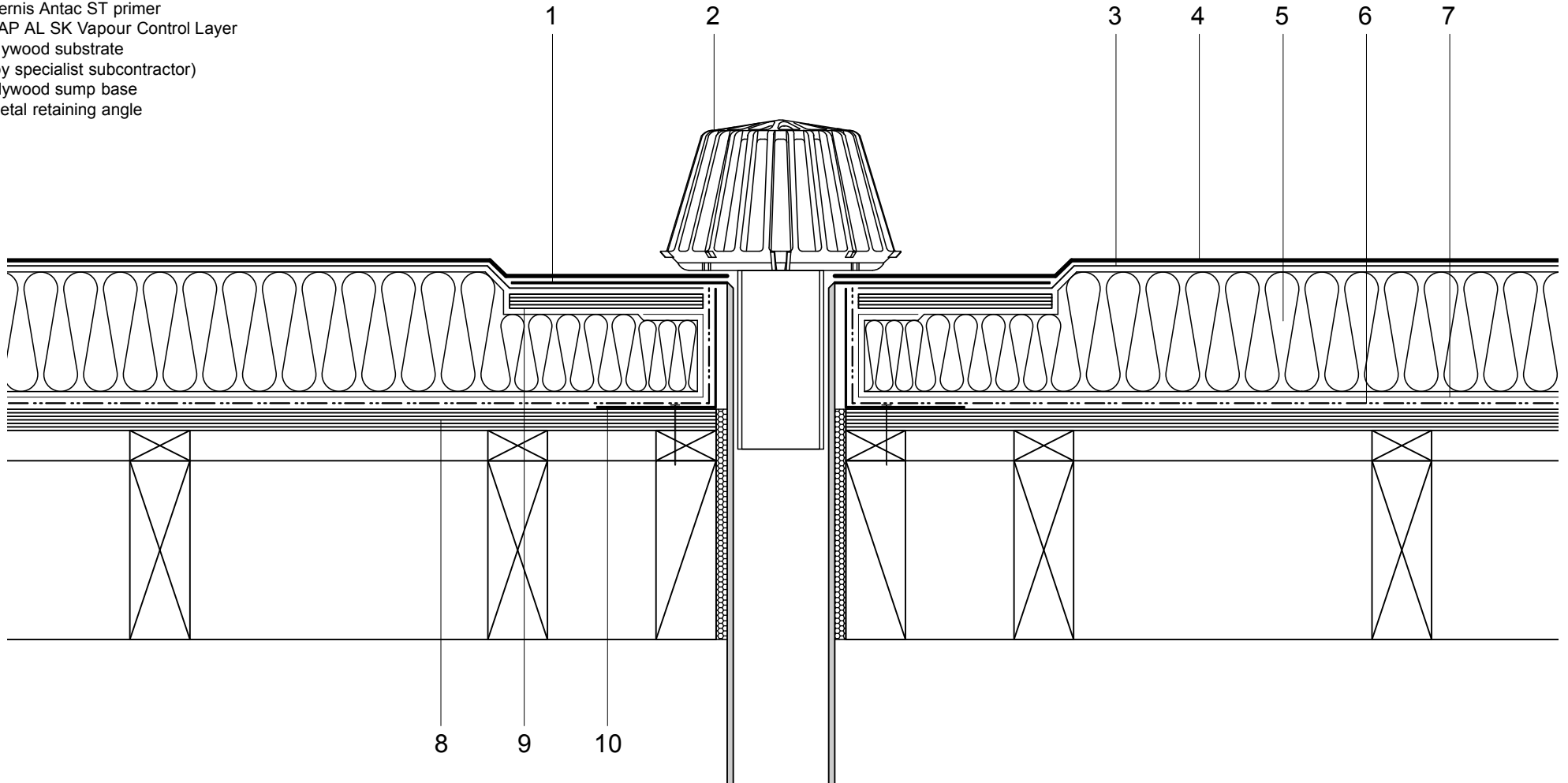

Do Not Scale. All dimensions to be checked on site by the Axtershield Installer

<p>Axter provides detail drawings as part of our technical design service. Such drawings should only be used as a guide during the design process and should not be utilised during construction. Axter accepts no liability for misuse of this service.</p>	<p>PROJECT</p> <p style="text-align: center;">AXTER - STANDARD DETAIL</p>	<p>DRAWING</p> <p style="text-align: center;">AXTER WARM ROOF - EXCEL/SPOT SYSTEM TYPICAL VERTICAL RAIN WATER OUTLET DETAIL - PLYWOOD SUBSTRATE</p>		<p>AXTER LTD West Road, Ransomes Europark, Ipswich, Suffolk, IP3 9SX. Tel:(01473)724056 Fax:(01473)723263 info@axterltd.co.uk</p>	
	<p>DRAWING NUMBER</p> <p style="text-align: center;">WR.P.EX.090</p>	<p>SCALE</p> <p style="text-align: center;">1:5 @ A4</p>	<p>DATE</p> <p style="text-align: center;">2014</p>		