

- 1 Axter perforated retaining angle to suit system depth
- 2 Ballast sterile area by specialist contractor
- 3 Force 4000 / 3000 Traffic capping membrane
- 4 Axter system under layer
- 5 18mm WBP plywood deck capping (fixed one side only) by specialist contractor
- 6 Timber packers to top by specialist contractor
- 7 Non-flammable compressible foam by specialist contractor
- 8 Force 4000 / 3000 detail membrane
- 9 Timber batten by specialist contractor
- 10 Force 4000 / 3000 to form welted drip detail
- 11 Axter living roof vegetation  
NB: Consult Axter for appropriate planting specification
- 12 HYDROSOIL (80mm min. settled depth) dependent on planting specification
- 13 HYDRODRAIN/20 drainage and filtration membrane (dependent on planting - refer Axter specification)
- 14 Vernis Antac ST / Vernis Seal primer
- 15 Axter system vapour control layer
- 16 35py Angle Strip
- 17 Hytherm tapered/flat board insulation (thickness to achieve design U value and/or design fall)
- 18 Concrete substrate by specialist subcontractor (laid to minimum 1:80 drainage falls when tapered insulation is not specified)

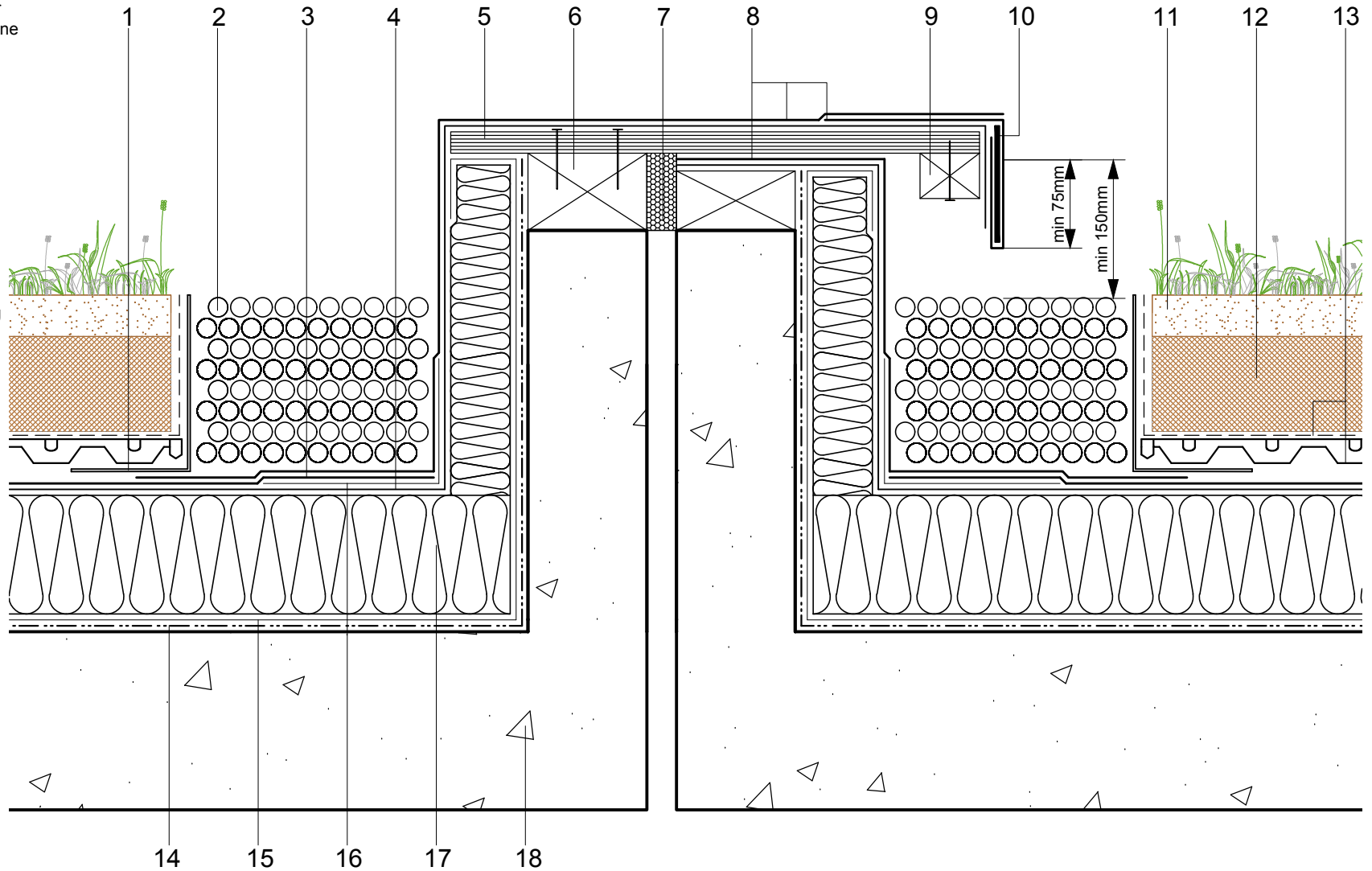

Axter provide detail drawings as part of our technical design service. Such drawings should only be used as a guide during the design process and should not be utilised during construction. Axter accepts no liability for misuse of this service.

|         |                       |               |   |       |     |  |
|---------|-----------------------|---------------|---|-------|-----|--|
| PROJECT | AXTER STANDARD DETAIL |               | DRAWING   |       |     |  |
|         |                       |               | CITYFLOR TYPICAL TWIN KERB EXPANSION JOINT DETAIL |       |     |  |
| CLIENT  | N/A                   | DWG.No        | SCALE   | DATE  | REV |  |
|         |                       | CF.C.0916.140 | 1:5 @A4   | 09.16 | N/A |  |



www.axter.co.uk  
info@axterltd.co.uk  
01473 724 056

Axter Ltd.  
West Road, Ransomes Europark,  
Ipswich, Suffolk, IP3 9SX