

- 1 Axter perforated retaining angle to suit system depth
- 2 Ballast sterile area by specialist contractor
- 3 Force 4000 / 3000 Traffic capping membrane
- 4 Axter system under layer
- 5 Axter I / tube washer and C / fixing
- 6 Axter living roof vegetation
NB: Consult Axter for appropriate planting specification
- 7 HYDROSOIL (80mm min. settled depth) dependent on planting specification
- 8 HYDRODRAIN/20 drainage and filtration membrane(dependent on planting - refer Axter specification)
- 9 Vernis Antac ST / Vernis Seal primer
- 10 Axter system vapour control layer
- 11 Hytherm tapered/flat board insulation (thickness to achieve design U value and/or design fall)
- 12 Axter cable penetration unit
- 13 Concrete substrate by specialist subcontractor (laid to minimum 1:80 drainage falls when tapered insulation is not specified)

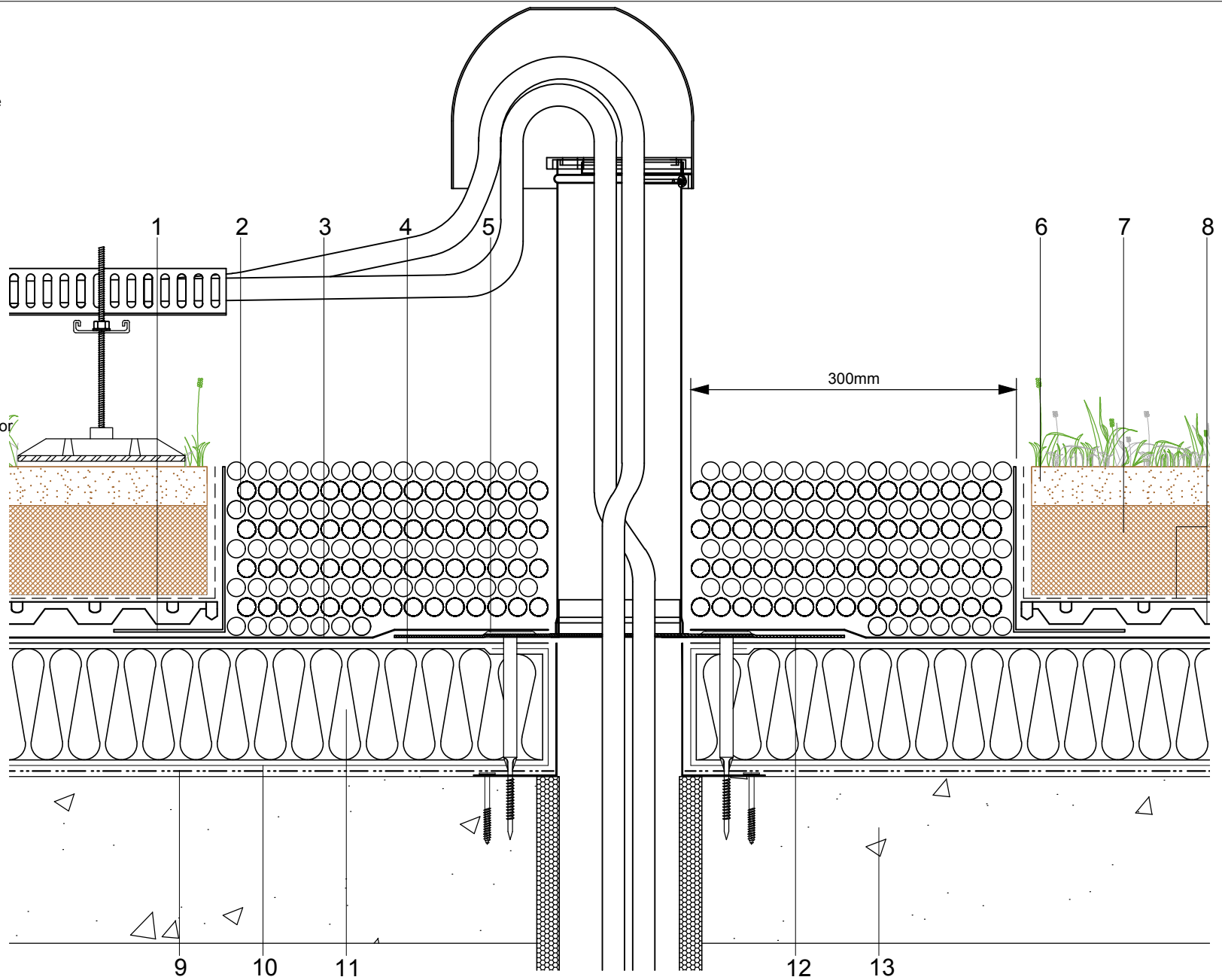

Axter provide detail drawings as part of our technical design service. Such drawings should only be used as a guide during the design process and should not be utilised during construction. Axter accepts no liability for misuse of this service.

PROJECT	AXTER STANDARD DETAIL
CLIENT	N/A

DRAWING	CITYFLOR TYPICAL PREFABRICATED CABLE PENETRATION DETAIL						
DWG.No	CF.C.0916.180	SCALE	1:5 @A4	DATE	09.16	REV	N/A



www.axter.co.uk
info@axterltd.co.uk
01473 724 056

Axter Ltd,
West Road, Ransomes Europark,
Ipswich, Suffolk, IP3 9SX