

- 1 ECOFLEX ADH fleeceback single ply membrane fully bonded using ADH Adhesive
- 2 Hytherm tapered/flat board Insulation mechanically fixed with Ecoflex insulation washers and fixings (thickness to achieve design U-value and/or design fall)
- 3 ECO/R coverstrip
- 4 ECOMETAL preformed PVC coated metal trim as hard edge
- 5 ECOFLEX ADH single ply membrane
- 6 Heat welded seam - 40mm
- 7 Vernis Antac ST primer
- 8 Axter Vapour Control Layer
- 9 Concrete substrate (by specialist subcontractor)
- 10 Restraint bar and mechanical (C) fixing
- 11 ADH Adhesive

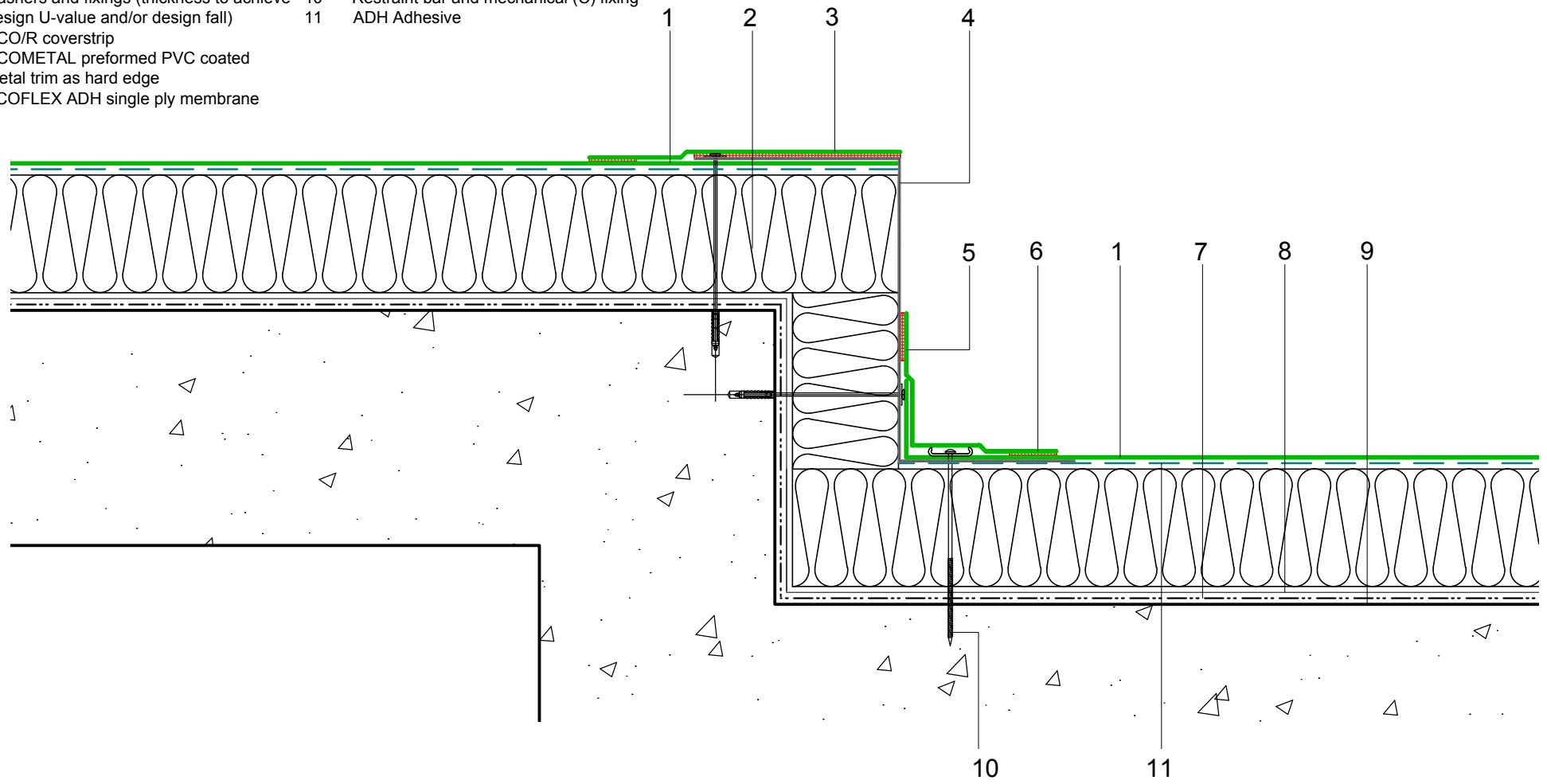

Do Not Scale. All dimensions to be checked on site by the Axtersfield Installer

<p>Axter provide detail drawings as part of our technical design service. Such drawings should only be used as a guide during the design process and should not be utilised during construction. Axter accepts no liability for misuse of this service.</p>	<p>PROJECT</p> <p style="text-align: center;">AXTER - STANDARD DETAIL</p>	<p>DRAWING</p> <p style="text-align: center;">AXTER WARM ROOF - ECOFLEX ADH SYSTEM TYPICAL CHANGE IN ROOF LEVEL/BOX GUTTER EDGE DETAIL - CONCRETE SUBSTRATE</p>				
	<p>CLIENT</p> <p style="text-align: center;">N/A</p>	<p>DWG.No</p> <p style="text-align: center;">WR.C.EF.adh.100</p>	<p>SCALE</p> <p style="text-align: center;">1:5 @ A4</p>	<p>DATE</p> <p style="text-align: center;">10.16</p>	<p>REV</p> <p style="text-align: center;">N/A</p>	