

- 1 ECOFLEX ADH fleecelback single ply membrane fully bonded using ADH Adhesive
- 2 Hytherm tapered/flat board Insulation mechanically fixed with Ecoflex insulation washers and fixings (thickness to achieve design U-value and/or design fall)
Reduced thickness to form gutter
- 3 Heat welded seam - 40mm
- 4 ECO/R cover strip
- 5 ECOMETAL preformed PVC coated metal gutter with mechanical (C) fixings at 200mm ctrs
- 6 Vernis Antac ST primer
- 7 Axter Vapour Control Layer
- 8 Concrete substrate (by specialist subcontractor)
- 9 ADH Adhesive

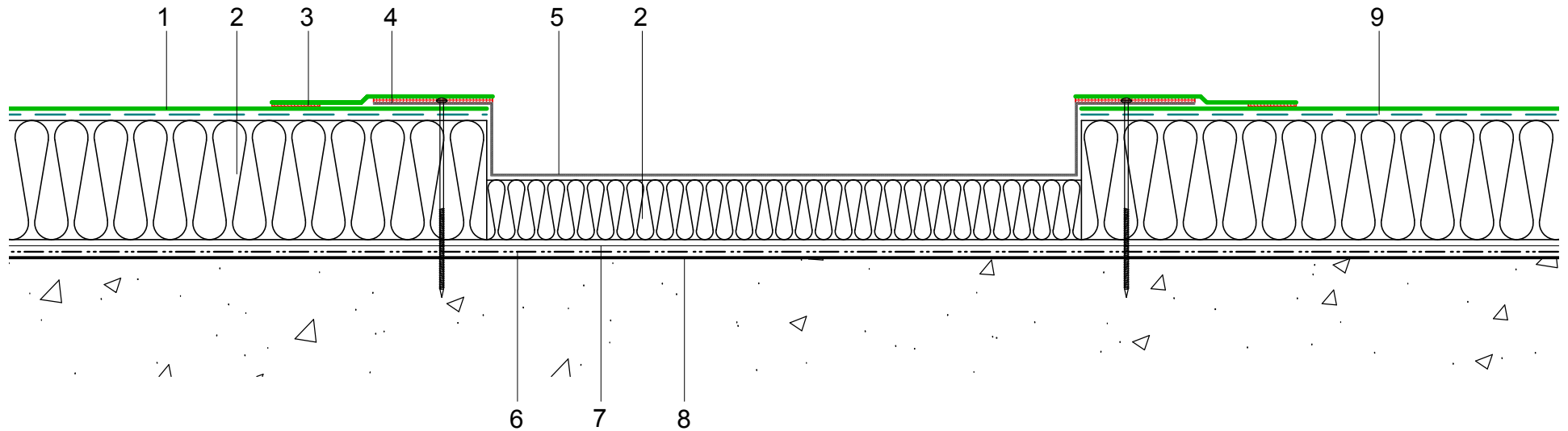

Do Not Scale. All dimensions to be checked on site by the Axtershield Installer

Axter provide detail drawings as part of our technical design service. Such drawings should only be used as a guide during the design process and should not be utilised during construction. Axter accepts no liability for misuse of this service.

<p>PROJECT</p> <p style="text-align: center;">AXTER - STANDARD DETAIL</p>	<p>DRAWING</p> <p style="text-align: center;">AXTER WARM ROOF - ECOFLEX ADH SYSTEM TYPICAL PRE-FORMED INTERNAL GUTTER DETAIL - CONCRETE SUBSTRATE</p>				
	<p>CLIENT</p> <p style="text-align: center;">N/A</p>	<p>DWG.No</p> <p style="text-align: center;">WR.C.EF.adh.191</p>			
<p>www.axter.co.uk info@axterltd.co.uk 01473 724 056</p>		<p style="text-align: right;">Axter Ltd. West Road, Ransomes Europark, Ipswich, Suffolk, IP3 9SX</p>			