

- 1 Axter Rainwater outlet with PVC membrane flange
- 2 Heat welded seam to field membrane
- 3 Axter Universal leaf guard (to suit design requirements)
- 4 ECOFLEX ADH fleeceback single ply membrane fully bonded using ADH Adhesive
- 5 Hytherm tapered/flat board Insulation mechanically fixed with Ecoflex insulation washers and fixings (thickness to achieve design U-value and/or design fall)  
nb: Insulation locally sumped (30mm min) on site by Axtershield Installer
- 6 Vernis Antac ST primer
- 7 Axter Vapour Control Layer
- 8 Plywood substrate (by specialist subcontractor)
- 9 ECOFLEX Tubular Washer and mechanical fastener (MTP) fixing
- 10 Galvanised bent metal angle mechanically fixed at perimeter (by specialist subcontractor)
- 11 ADH Adhesive

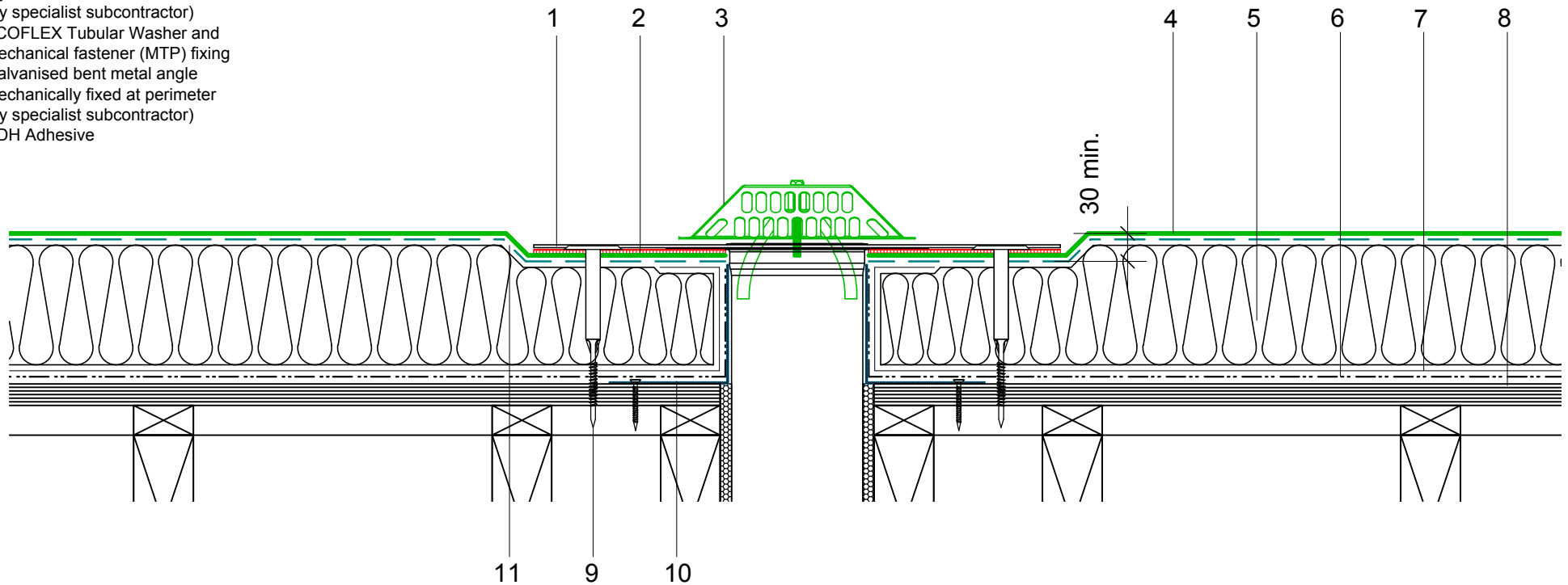

Do Not Scale. All dimensions to be checked on site by the Axtershield Installer

Axter provide detail drawings as part of our technical design service. Such drawings should only be used as a guide during the design process and should not be utilised during construction. Axter accepts no liability for misuse of this service.

PROJECT	AXTER - STANDARD DETAIL		DRAWING	AXTER WARM ROOF - ECOFLEX ADH SYSTEM TYPICAL VERTICAL RAIN WATER OUTLET DETAIL - PLYWOOD SUBSTRATE		
	CLIENT	N/A		DWG.No	SCALE	DATE
			WR.P.EF.adh.80	1:5 @ A4	10.16	N/A



www.axter.co.uk  
info@axterltd.co.uk  
01473 724 056

Axter Ltd.  
West Road, Ransomes Europark,  
Ipswich, Suffolk, IP3 9SX