

- 1 ECOFLEX FM single ply membrane mechanically fixed with Ecoflex membrane washers and (MTP) fixings
- 2 Hytherm tapered/flat board Insulation mechanically fixed with Ecoflex insulation washers and fixings (thickness to achieve design U-value and/or design fall)
Reduced thickness to form gutter
- 3 Heat welded seam - 40mm
- 4 ECO/R cover strip
- 5 ECOMETAL preformed PVC coated metal gutter with mechanical (MTP) fixings at 200mm ctrs
- 6 Vernis Antac ST primer
- 7 Axter Vapour Control Layer
- 8 Plywood substrate
(by specialist subcontractor)

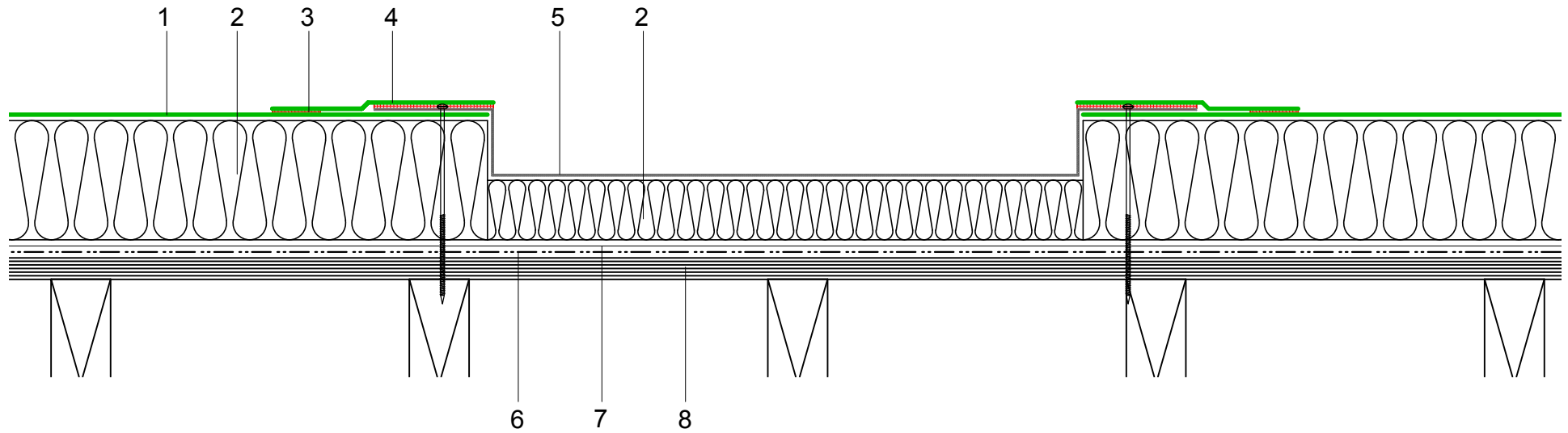

Do Not Scale. All dimensions to be checked on site by the Axtershield Installer

Axter provide detail drawings as part of our technical design service. Such drawings should only be used as a guide during the design process and should not be utilised during construction. Axter accepts no liability for misuse of this service.

<p>PROJECT</p> <p style="text-align: center;">AXTER - STANDARD DETAIL</p>	<p>DRAWING</p> <p style="text-align: center;">AXTER WARM ROOF - ECOFLEX FM SYSTEM TYPICAL PRE-FORMED INTERNAL GUTTER DETAIL - PLYWOOD SUBSTRATE</p>					
	<p>CLIENT</p> <p style="text-align: center;">N/A</p>	<p>DWG.No</p> <p style="text-align: center;">WR.P.EF.fm.191</p>				